

Nokia Customer Care
RH-51/52, RH-67/68 Series Cellular Phones

**2 - Parts Lists and Component
Layout**

This page has been deliberately left blank

Table of Contents

	Page No
Exploded view of RH-51/52, RH-67/68	5
Assembly parts list	6
Mechanical parts	6
Variant parts (RH-51/52).....	7
Variant parts (RH-67/68).....	8
Swap units (RH-51/52)	8
Swap units (RH-67/68)	8
Parts list for RH-51/52, RH-67/68 module (1BZ_060a).....	9
Component layout diagram bottom	29
Component layout diagram top	30

This page has been deliberately left blank

Exploded view of RH-51/52, RH-67/68

This is the view of RH-51/52. However, RH-67/68 has the same mechanical construction, different design in the following parts: I001 A-cover, I002 Keymat, I006 Dome Sheet, I025 C-cover.

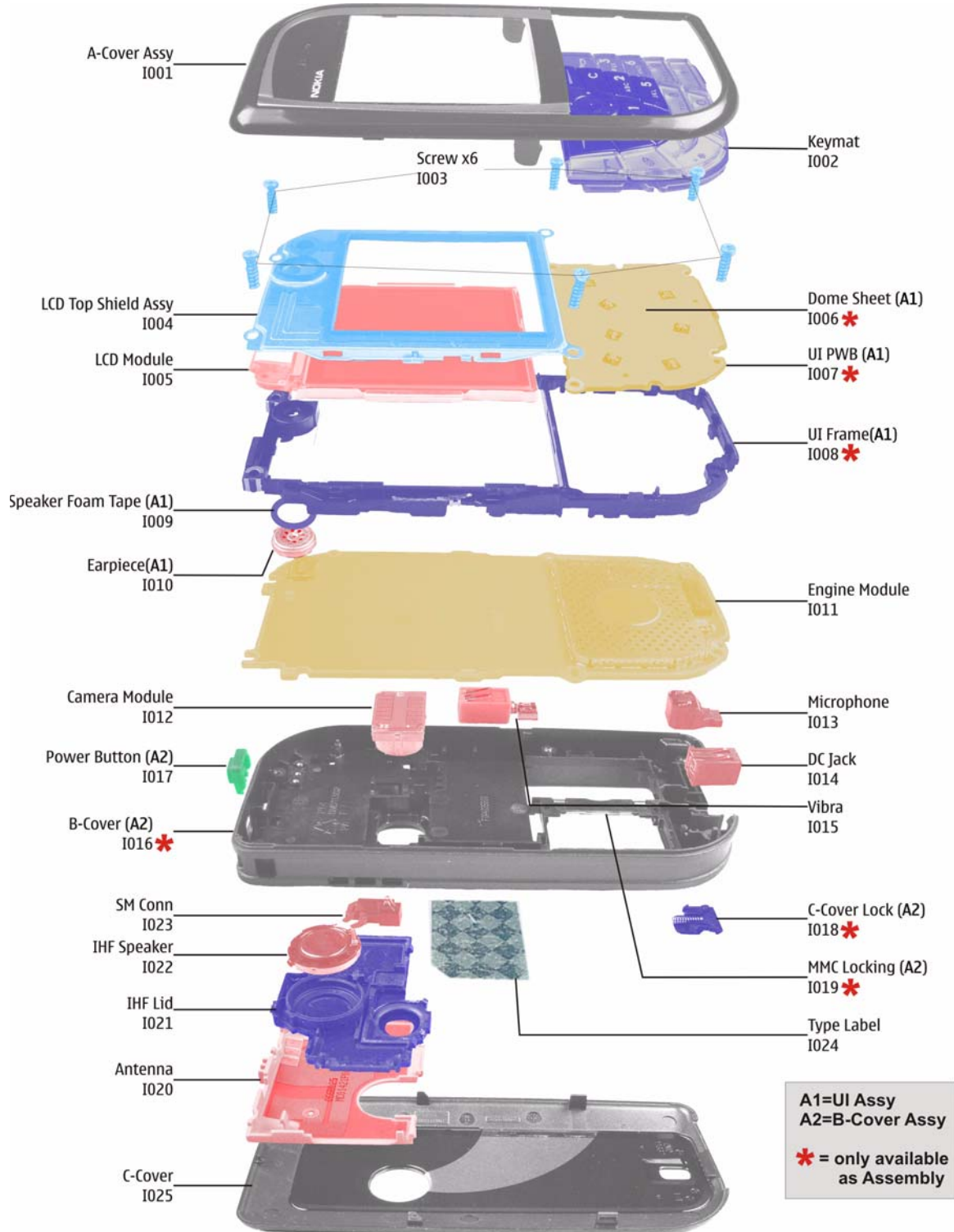

Assembly parts list

Mechanical parts

Item/ _Circuit	Qty	Parts number		Parts name
		RH-51/52	RH-67/68	
I001	1	xxxxxxx	xxxxxxx	A-COVER ASSY
I002	1	xxxxxxx	xxxxxxx	KEYMAT
I003	6	6290093	<<	SCREW_1.8X8_FEZN_T6+
I004	1	9511424	<<	LCD_TOP_SHIELD_ASSY_
I005	1	4850831	<<	LCD_MODULE_176X208_
-	1	9481177	0264093	UI_ASSY (I006 - I010)
-	1	0264062	0263730	UI PWB ASSY FOR AMS (I006 - I007, APAC/ China only)
I006	1	-	-	DOME SHEET
I007	1	-	-	UI PWB
I008	1	0264061	<<	UI FRAME ASSY FOR AMS (APAC/China only)
I009	1	9470283	<<	SPEAKER_FOAM_TAPE_
I010	1	5140251	<<	EARPIECE105+-3DB32RD8.1X2.25_
I011	1	-	-	ENGINE MODULE
I012	1	4858045	<<	CAMERA MODULE
I013	1	5140265	<<	MICROPHONE
I014	1	5400243	<<	DC-JACK
I015	1	6800069	<<	VIBRA
-	1	0264053	<<	B-COVER ASSY FOR AMS (I016 - I019)
I016	1	-	-	B-COVER
I017	1	9453470	<<	POWER BUTTON
I018	1	-	-	C-COVER LOCK
I019	1	-	-	MMC LOCKINIG
I020	1	5650069	<<	ANTENNA (RH-51/RH-67)
I020	1	5650071	-	ANTENNA (RH-52)

Item/ _Circuit	Qty	Parts number		Parts name
		RH-51/52	RH-67/68	
I020	1	-	5650201	ANTENNA (RH-68)
I021	1	9467125	<<	IHF LID
I022	1	5140253	<<	IHF SPEAKER
I023	1	5469941	<<	SM_CONN (IHF SPEAKER CONNECTOR)
I024	1	9381478	<<	TYPE LABEL
I025	1	xxxxxxx	xxxxxxx	C-COVER

Variant parts (RH-51/52)

Item	Qty	Part Code	Part Name
I001	1	9459991	A-COVER ASSY (Piano Piano Black/Red)
I001	1	9459992	A-COVER ASSY (Piano Black/Brown)
I001	1	9459993	A-COVER ASSY (Pearl Silver)
I002	1	9791226	KEYMAT (Latin - Piano Black/Red)
I002	1	9792057	KEYMAT (Latin - Piano Black/Brown)
I002	1	9792058	KEYMAT (Latin - Pearl Silver)
I002	1	9792047	KEYMAT (Arabic - Piano Black/Red)
I002	1	9792046	KEYMAT (Arabic - Pearl Silver)
I002	1	9792048	KEYMAT (Hebrew - Piano Black/Red)
I002	1	9792049	KEYMAT (Hebrew - Pearl Silver)
I002	1	9792045	KEYMAT (Greek Cyrillic - Piano Black/Red)
I002	1	9792044	KEYMAT (Greek Cyrillic - Pearl Silver)
I002	1	9792042	KEYMAT (Russian Cyrillic - Piano Black/Red)
I002	1	9792043	KEYMAT (Russian Cyrillic - Pearl Silver)
I002	1	9792052	KEYMAT (Stroke - Piano Black/Brown)
I002	1	9792051	KEYMAT (Stroke - Piano Black/Red)
I002	1	9792050	KEYMAT (Stroke - Pearl Silver)
I002	1	9792053	KEYMAT (BoPoMoFo - Piano Black/Brown)
I002	1	9792054	KEYMAT (BoPoMoFo - Pearl Silver)
I025	1	9459951	C-COVER ASSY (Piano Black/Red)
I025	1	9455003	C-COVER ASSY (Piano Black/Brown)
I025	1	9455004	C-COVER ASSY (Pearl Silver)

Variant parts (RH-67/68)

Item	Qty	Parts code	Parts name
I001	1	0266523	A-COVER ASSY (Aluminium grey)
I001	1	0266524	A-COVER ASSY (Deep blue)
I002	1	9797288	KEYMAT (Latin)
I002	1	9797292	KEYMAT (Arabic)
I002	1	9797293	KEYMAT (Hebrew)
I002	1	9797291	KEYMAT (Greek Cyrillic)
I002	1	9797290	KEYMAT (Russian Cyrillic)
I002	1	9797294	KEYMAT (Stroke)
I002	1	9797296	KEYMAT (BoPoMoFo)
I002	1	9797297	KEYMAT (Thai)
I025	1	0266525	C-COVER ASSY (Aluminium grey)
I025	1	0266530	C-COVER ASSY (Deep blue)

Swap units (RH-51/52)

Part code	Swap name
0516054	RH-51 N7610 SWAP ENGINE FRANCE
0516058	RH-51 N7610 SWAP ENGINE SOUTH AFRICA
0516060	RH-51 N7610 SWAP ENGINE RUSSIAN
0516061	RH-51 N7610 SWAP ENGINE UKRAINE
0516053	RH-51 N7610 SWAP ENGINE EURO A
0517333	RH-51 N7610 SWAP ENGINE TURKEY

Swap units (RH-67/68)

Parts code	Swap name
0520013	RH-67 N6670 SWAP ENGINE EURO A
0520014	RH-67 N6670 SWAP ENGINE FRANCE
0520015	RH-67 N6670 SWAP ENGINE UKRAINE
0520016	RH-67 N6670 SWAP ENGINE RUSSIAN
0520017	RH-67 N6670 SWAP ENGINE TURKEY
0520018	RH-67 N6670 SWAP ENGINE SOUTH AFRICA

Parts list for RH-51/52, RH-67/68 module (1BZ_060a)

Item	Part Number	Side	X	Y	Description and value				Type
A100	9517363	Bot	R	7	SIDE A SHIELD ASSY DMC06936 R1024	~	~	~	SHIELD_DMC06936
A200	9517364	Top	K	6	SIDE B SHIELD ASSY DMC06937 R1024	~	~	~	SHIELD_DMC06937
A300	9517361	Top	D	7	HELGO SHIELD ASSY DMC06934 R1024	~	~	~	SHIELD_DMC06934
A400	9517362	Top	F	3	PA SHIELD ASSY DMC06935 R1024	~	~	~	SHIELD_DMC06935
B250	4510405	Top	J	8	CRYSTAL 32.768KHZ+-20PPM 12.5PF	32.768kHz	~	~	CRYSTAL_FC_255
B440	4530007	Bot	T	7	CRYSTAL 6MHZ+0.11% -0.09% 4.5X2.0	6MHz	~	~	CSTCR6M00G15B
C132	2320481	Top	J	3	CHIPCAP X5R 1U K 6V3 0603	1u0	6.3V	normal,-10%,10%	0603C
C133	2611753	Top	H	3	CHIPTCAP 33U M 16V 6.0X3.2X1.5	33u_16V	16V	normal,-20%,20%	TANT_TPSW2
C134	2320110	Top	T	8	Cer. cap 10% 50V 0603	10n	50V	normal,-10%,10%	0603C
C135	2320546	Top	T	8	Chipcap 5% NPO	27p	50V	normal,-5%,5%	0402C
C190	2320540	Bot	T	5	Chipcap 5% NPO	15p	50V	normal,-5%,5%	0402C
C191	2320520	Bot	T	4	Chipcap +-0.25pF NPO	2p2	50V	normal,-0.25pF,0.25pF	0402C
C192	2320520	Bot	T	5	Chipcap +-0.25pF NPO	2p2	50V	normal,-0.25pF,0.25pF	0402C
C193	2320560	Bot	R	3	Chipcap 5% NPO	100p	50V	normal,-5%,5%	0402C
C194	2320520	Bot	S	4	Chipcap +-0.25pF NPO	2p2	50V	normal,-0.25pF,0.25pF	0402C
C195	2320778	Bot	S	3	Chipcap X7R 10% 16V 0402	10n	16V	normal,-10%,10%	0402C
C196	2320778	Bot	S	4	Chipcap X7R 10% 16V 0402	10n	16V	normal,-10%,10%	0402C
C197	2320540	Bot	T	5	Chipcap 5% NPO	15p	50V	normal,-5%,5%	0402C
C198	2320778	Bot	R	5	Chipcap X7R 10% 16V 0402	10n	16V	normal,-10%,10%	0402C
C199	2316001	Bot	R	5	CHIPCAP X5R 2U2 K 6V3 0603	2u2	6V3	normal,-10%,10%	0603C
C200	2320572	Bot	T	4	Chipcap 5% X7R	330p	50V	normal,-5%,5%	0402C

Item	Part Number	Side	X	Y	Description and value	Type
C201	2320778	Bot	T	3	Chipcap X7R 10% 16V 0402	10n 16V normal,-10%,10% 0402C
C203	2320481	Bot	R	4	CHIPCAP X5R 1U K 6V3 0603	1u0 6.3V normal,-10%,10% 0603C
C204	2320778	Bot	S	4	Chipcap X7R 10% 16V 0402	10n 16V normal,-10%,10% 0402C
C220	2320481	Top	K	5	CHIPCAP X5R 1U K 6V3 0603	1u0 6.3V normal,-10%,10% 0603C
C221	2320481	Top	K	5	CHIPCAP X5R 1U K 6V3 0603	1u0 6.3V normal,-10%,10% 0603C
C222	2310037	Top	K	4	CHIPCAP X5R 10U M 6V3 0805	10U 6V3 normal,-20%,20% 0805C
C230	2310037	Bot	P	4	CHIPCAP X5R 10U M 6V3 0805	10U 6V3 normal,-20%,20% 0805C
C231	2320552	Bot	P	4	Chipcap 5% NP0	47p 50V normal,-5%,5% 0402C
C232	2310037	Bot	P	5	CHIPCAP X5R 10U M 6V3 0805	10U 6V3 normal,-20%,20% 0805C
C233	2310037	Bot	P	5	CHIPCAP X5R 10U M 6V3 0805	10U 6V3 normal,-20%,20% 0805C
C239	2320481	Top	K	2	CHIPCAP X5R 1U K 6V3 0603	1u0 6.3V normal,-10%,10% 0603C
C240	2320481	Top	J	3	CHIPCAP X5R 1U K 6V3 0603	1u0 6.3V normal,-10%,10% 0603C
C241	2320805	Top	K	3	CHIPCAP X5R 100N K 10V 0402	100n 10V normal,-10%,10% 0402C
C250	2320481	Top	J	6	CHIPCAP X5R 1U K 6V3 0603	1u0 6.3V normal,-10%,10% 0603C
C251	2320481	Top	K	5	CHIPCAP X5R 1U K 6V3 0603	1u0 6.3V normal,-10%,10% 0603C
C252	2320481	Top	M	8	CHIPCAP X5R 1U K 6V3 0603	1u0 6.3V normal,-10%,10% 0603C
C253	2320536	Top	J	7	Chipcap 5% NP0	10p 50V normal,-5%,5% 0402C
C254	2320536	Top	J	8	Chipcap 5% NP0	10p 50V normal,-5%,5% 0402C
C255	2320481	Top	J	8	CHIPCAP X5R 1U K 6V3 0603	1u0 6.3V normal,-10%,10% 0603C
C256	2320481	Top	J	7	CHIPCAP X5R 1U K 6V3 0603	1u0 6.3V normal,-10%,10% 0603C
C257	2320481	Top	J	8	CHIPCAP X5R 1U K 6V3 0603	1u0 6.3V normal,-10%,10% 0603C

Item	Part Number	Side	X	Y	Description and value	Type
C258	2320805	Top	K	8	CHIPCAP X5R 100N K 10V 0402	100n 10V normal,-10%,10% 0402C
C259	2320481	Top	K	9	CHIPCAP X5R 1U K 6V3 0603	1u0 6.3V normal,-10%,10% 0603C
C260	2320544	Top	L	8	Chipcap 5% NPO	22p 50V normal,-5%,5% 0402C
C261	2320544	Top	L	9	Chipcap 5% NPO	22p 50V normal,-5%,5% 0402C
C262	2320544	Top	L	9	Chipcap 5% NPO	22p 50V normal,-5%,5% 0402C
C263	2320544	Top	K	9	Chipcap 5% NPO	22p 50V normal,-5%,5% 0402C
C264	2320544	Top	K	9	Chipcap 5% NPO	22p 50V normal,-5%,5% 0402C
C265	2320544	Top	K	9	Chipcap 5% NPO	22p 50V normal,-5%,5% 0402C
C266	2320544	Top	J	9	Chipcap 5% NPO	22p 50V normal,-5%,5% 0402C
C267	2320544	Top	J	8	Chipcap 5% NPO	22p 50V normal,-5%,5% 0402C
C268	2320805	Top	M	7	CHIPCAP X5R 100N K 10V 0402	100n 10V normal,-10%,10% 0402C
C269	2320805	Top	M	7	CHIPCAP X5R 100N K 10V 0402	100n 10V normal,-10%,10% 0402C
C270	2320778	Top	M	8	Chipcap X7R 10% 16V 0402	10n 16V normal,-10%,10% 0402C
C271	2320778	Top	M	8	Chipcap X7R 10% 16V 0402	10n 16V normal,-10%,10% 0402C
C272	2320744	Top	J	8	Chipcap X7R 10% 50V 0402	1n0 50V normal,-10%,10% 0402C
C273	2320744	Top	J	8	Chipcap X7R 10% 50V 0402	1n0 50V normal,-10%,10% 0402C
C274	2320481	Top	J	6	CHIPCAP X5R 1U K 6V3 0603	1u0 6.3V normal,-10%,10% 0603C
C275	2320778	Top	J	6	Chipcap X7R 10% 16V 0402	10n 16V normal,-10%,10% 0402C
C276	2320744	Top	J	6	Chipcap X7R 10% 50V 0402	1n0 50V normal,-10%,10% 0402C
C277	2320805	Top	L	9	CHIPCAP X5R 100N K 10V 0402	100n 10V normal,-10%,10% 0402C
C278	2320481	Top	J	7	CHIPCAP X5R 1U K 6V3 0603	1u0 6.3V normal,-10%,10% 0603C

Item	Part Number	Side	X	Y	Description and value	Type
C279	2320481	Top	J	7	CHIPCAP X5R 1U K 6V3 0603	1u0 6.3V normal,-10%,10% 0603C
C280	2320481	Top	J	6	CHIPCAP X5R 1U K 6V3 0603	1u0 6.3V normal,-10%,10% 0603C
C281	2320481	Top	K	5	CHIPCAP X5R 1U K 6V3 0603	1u0 6.3V normal,-10%,10% 0603C
C282	2320481	Top	L	8	CHIPCAP X5R 1U K 6V3 0603	1u0 6.3V normal,-10%,10% 0603C
C283	2320805	Top	L	8	CHIPCAP X5R 100N K 10V 0402	100n 10V normal,-10%,10% 0402C
C284	2320481	Top	M	8	CHIPCAP X5R 1U K 6V3 0603	1u0 6.3V normal,-10%,10% 0603C
C285	2320805	Top	M	6	CHIPCAP X5R 100N K 10V 0402	100n 10V normal,-10%,10% 0402C
C286	2320805	Top	M	6	CHIPCAP X5R 100N K 10V 0402	100n 10V normal,-10%,10% 0402C
C287	2320481	Top	L	5	CHIPCAP X5R 1U K 6V3 0603	1u0 6.3V normal,-10%,10% 0603C
C288	2320481	Top	L	5	CHIPCAP X5R 1U K 6V3 0603	1u0 6.3V normal,-10%,10% 0603C
C289	2320481	Top	L	5	CHIPCAP X5R 1U K 6V3 0603	1u0 6.3V normal,-10%,10% 0603C
C290	2320481	Top	L	5	CHIPCAP X5R 1U K 6V3 0603	1u0 6.3V normal,-10%,10% 0603C
C291	2320481	Top	M	5	CHIPCAP X5R 1U K 6V3 0603	1u0 6.3V normal,-10%,10% 0603C
C292	2320805	Top	K	6	CHIPCAP X5R 100N K 10V 0402	100n 10V normal,-10%,10% 0402C
C293	2320805	Top	K	6	CHIPCAP X5R 100N K 10V 0402	100n 10V normal,-10%,10% 0402C
C294	2320481	Top	K	5	CHIPCAP X5R 1U K 6V3 0603	1u0 6.3V normal,-10%,10% 0603C
C295	2320481	Top	K	5	CHIPCAP X5R 1U K 6V3 0603	1u0 6.3V normal,-10%,10% 0603C
C296	2320481	Top	K	6	CHIPCAP X5R 1U K 6V3 0603	1u0 6.3V normal,-10%,10% 0603C
C297	2320481	Top	L	6	CHIPCAP X5R 1U K 6V3 0603	1u0 6.3V normal,-10%,10% 0603C
C298	2320481	Top	L	5	CHIPCAP X5R 1U K 6V3 0603	1u0 6.3V normal,-10%,10% 0603C
C299	2320481	Top	L	5	CHIPCAP X5R 1U K 6V3 0603	1u0 6.3V normal,-10%,10% 0603C

Item	Part Number	Side	X	Y	Description and value	Type
C300	2320481	Top	K	5	CHIPCAP X5R 1U K 6V3 0603	1u0 6.3V normal,-10%,10% 0603C
C301	2320481	Top	L	5	CHIPCAP X5R 1U K 6V3 0603	1u0 6.3V normal,-10%,10% 0603C
C302	2320481	Top	L	5	CHIPCAP X5R 1U K 6V3 0603	1u0 6.3V normal,-10%,10% 0603C
C312	2320805	Top	M	4	CHIPCAP X5R 100N K 10V 0402	100n 10V normal,-10%,10% 0402C
C314	2320481	Top	S	11	CHIPCAP X5R 1U K 6V3 0603	1u0 6.3V normal,-10%,10% 0603C
C315	2310793	Top	R	11	CHIPCAP X5R 2U2 K 10V 0805	2u2 10V normal,-10%,10% 0805C
C316	2320778	Top	Q	11	Chipcap X7R 10% 16V 0402	10n 16V normal,-10%,10% 0402C
C317	2320805	Top	T	11	CHIPCAP X5R 100N K 10V 0402	100n 10V normal,-10%,10% 0402C
C370	2320805	Bot	O	9	CHIPCAP X5R 100N K 10V 0402	100n 10V normal,-10%,10% 0402C
C371	2320805	Bot	O	10	CHIPCAP X5R 100N K 10V 0402	100n 10V normal,-10%,10% 0402C
C372	2320805	Bot	R	8	CHIPCAP X5R 100N K 10V 0402	100n 10V normal,-10%,10% 0402C
C373	2320805	Bot	P	7	CHIPCAP X5R 100N K 10V 0402	100n 10V normal,-10%,10% 0402C
C374	2320805	Bot	O	9	CHIPCAP X5R 100N K 10V 0402	100n 10V normal,-10%,10% 0402C
C375	2320805	Bot	Q	10	CHIPCAP X5R 100N K 10V 0402	100n 10V normal,-10%,10% 0402C
C376	2320805	Bot	R	7	CHIPCAP X5R 100N K 10V 0402	100n 10V normal,-10%,10% 0402C
C377	2320805	Bot	O	8	CHIPCAP X5R 100N K 10V 0402	100n 10V normal,-10%,10% 0402C
C378	2320805	Bot	O	10	CHIPCAP X5R 100N K 10V 0402	100n 10V normal,-10%,10% 0402C
C379	2320805	Bot	Q	10	CHIPCAP X5R 100N K 10V 0402	100n 10V normal,-10%,10% 0402C
C380	2320805	Bot	R	10	CHIPCAP X5R 100N K 10V 0402	100n 10V normal,-10%,10% 0402C
C381	2320805	Bot	R	8	CHIPCAP X5R 100N K 10V 0402	100n 10V normal,-10%,10% 0402C
C382	2320805	Bot	O	7	CHIPCAP X5R 100N K 10V 0402	100n 10V normal,-10%,10% 0402C

Item	Part Number	Side	X	Y	Description and value	Type
C383	2320778	Bot	Q	10	Chipcap X7R 10% 16V 0402	10n 16V normal,-10%,10% 0402C
C400	2310037	Bot	T	9	CHIPCAP X5R 10U M 6V3 0805	10U 6V3 normal,-20%,20% 0805C
C401	2312257	Bot	T	10	CHIPCAP X7R 330N K 16V 0805	330n 16V normal,-10%,10% 0805C
C402	2320481	Bot	T	8	CHIPCAP X5R 1U K 6V3 0603	1u0 6.3V normal,-10%,10% 0603C
C403	2312257	Bot	T	8	CHIPCAP X7R 330N K 16V 0805	330n 16V normal,-10%,10% 0805C
C404	2320552	Top	G	10	Chipcap 5% NP0	47p 50V normal,-5%,5% 0402C
C405	2312243	Top	F	10	CHIPCAP X5R 4U7 K 6V3 0805	4u7 6V3 normal,-10%,10% 0805C
C406	2312411	Top	F	9	CHIPCAP X5R 1U0 M 25V 1206	1u0 25V normal,-20%,20% 1206_BLM
C407	2312411	Top	E	9	CHIPCAP X5R 1U0 M 25V 1206	1u0 25V normal,-20%,20% 1206_BLM
C408	2320805	Bot	C	4	CHIPCAP X5R 100N K 10V 0402	100n 10V normal,-10%,10% 0402C
C409	2320805	Bot	D	3	CHIPCAP X5R 100N K 10V 0402	100n 10V normal,-10%,10% 0402C
C410	2320805	Bot	D	4	CHIPCAP X5R 100N K 10V 0402	100n 10V normal,-10%,10% 0402C
C411	2310037	Bot	S	8	CHIPCAP X5R 10U M 6V3 0805	10U 6V3 normal,-20%,20% 0805C
C420	2320805	Top	H	9	CHIPCAP X5R 100N K 10V 0402	100n 10V normal,-10%,10% 0402C
C422	2320805	Top	G	9	CHIPCAP X5R 100N K 10V 0402	100n 10V normal,-10%,10% 0402C
C440	2320805	Bot	T	6	CHIPCAP X5R 100N K 10V 0402	100n 10V normal,-10%,10% 0402C
C441	2320805	Bot	T	6	CHIPCAP X5R 100N K 10V 0402	100n 10V normal,-10%,10% 0402C
C442	2320805	Bot	S	6	CHIPCAP X5R 100N K 10V 0402	100n 10V normal,-10%,10% 0402C
C443	2320805	Bot	S	6	CHIPCAP X5R 100N K 10V 0402	100n 10V normal,-10%,10% 0402C
C444	2320125	Bot	T	7	CHIPCAP X5R 1U K 16V 0603	1u0 16V normal,-10%,10% 0603C
C445	2320544	Top	T	8	Chipcap 5% NP0	22p 50V normal,-5%,5% 0402C

Item	Part Number	Side	X	Y	Description and value	Type
C446	2320544	Top	T	7	Chipcap 5% NPO	22p 50V normal,-5%,5%
C447	2320544	Top	T	7	Chipcap 5% NPO	22p 50V normal,-5%,5%
C460	2320779	Bot	Q	7	CHIPCAP X7R 100N K 16V 0603	100n 16V normal,-10%,10%
C461	2320805	Bot	Q	5	CHIPCAP X5R 100N K 10V 0402	100n 10V normal,-10%,10%
C462	2320805	Bot	S	6	CHIPCAP X5R 100N K 10V 0402	100n 10V normal,-10%,10%
C463	2320779	Bot	R	8	CHIPCAP X7R 100N K 16V 0603	100n 16V normal,-10%,10%
C464	2320779	Bot	S	8	CHIPCAP X7R 100N K 16V 0603	100n 16V normal,-10%,10%
C465	2320779	Bot	S	8	CHIPCAP X7R 100N K 16V 0603	100n 16V normal,-10%,10%
C466	2320779	Bot	T	10	CHIPCAP X7R 100N K 16V 0603	100n 16V normal,-10%,10%
C470	2320779	Bot	O	7	CHIPCAP X7R 100N K 16V 0603	100n 16V normal,-10%,10%
C471	2320805	Bot	Q	5	CHIPCAP X5R 100N K 10V 0402	100n 10V normal,-10%,10%
C472	2320805	Bot	O	5	CHIPCAP X5R 100N K 10V 0402	100n 10V normal,-10%,10%
C490	2320560	Top	M	6	Chipcap 5% NPO	100p 50V normal,-5%,5%
C491	2320536	Bot	Q	10	Chipcap 5% NPO	10p 50V normal,-5%,5%
C500	2320481	Top	C	5	CHIPCAP X5R 1U K 6V3 0603	1u0 6.3V normal,-10%,10%
C501	2320536	Top	C	5	Chipcap 5% NPO	10p 50V normal,-5%,5%
C502	2320631	Top	B	7	CHIPCAP NPO 180P J 25V 0402	180p 25V normal,-5%,5%
C503	2318001	Top	C	7	CHIPCAP NPO 2N7 J 25V 0805	2n7 25V normal,-5%,5%
C504	2321013	Top	C	7	CHIPCAP NPO 270P J 25V 0402	270p 25V normal,-5%,5%
C505	2322023	Top	F	8	CHIPCAP NPO 2N2 J 16V 0603	2n2 16V normal,-5%,5%
C506	2320560	Top	F	8	Chipcap 5% NPO	100p 50V normal,-5%,5%

Item	Part Number	Side	X	Y	Description and value	Type	
C510	2320554	Top	E	8	Chipcap 5% NPO	56p 50V normal,-5%,5%	0402C
C511	2320514 (RH-51, RH-67)	Top	E	7	Chipcap +-0.25pF NPO	1p2 50V normal,-0.25pF,0.25pF	0402C
C511	2320516 (RH-52, RH-68)	Top	E	7	Chipcap +-0.25pF NPO	1p5 50V normal,-0.25pF,0.25pF	0402C
C512	2320604	Top	E	8	Chipcap 5% NPO	18p 50V normal,-5%,5%	0402C
C513	2320778	Top	E	8	Chipcap X7R 10% 16V 0402	10n 16V normal,-10%,10%	0402C
C516	2320546	Top	D	7	Chipcap 5% NPO	27p 50V normal,-5%,5%	0402C
C517	2320805	Top	D	7	CHIPCAP X5R 100N K 10V 0402	100n 10V normal,-10%,10%	0402C
C518	2320536	Top	D	6	Chipcap 5% NPO	10p 50V normal,-5%,5%	0402C
C519	2320805	Top	D	6	CHIPCAP X5R 100N K 10V 0402	100n 10V normal,-10%,10%	0402C
C520	2320554	Top	E	6	Chipcap 5% NPO	56p 50V normal,-5%,5%	0402C
C521	2320805	Top	D	6	CHIPCAP X5R 100N K 10V 0402	100n 10V normal,-10%,10%	0402C
C522	2320778	Top	D	7	Chipcap X7R 10% 16V 0402	10n 16V normal,-10%,10%	0402C
C523	2315017	Top	D	5	CHIP ARRAY NPO 4X470P K 16V 0612	4x470p 16V normal,-10%,10%	0612_H0.94
C524	2320805	Top	D	5	CHIPCAP X5R 100N K 10V 0402	100n 10V normal,-10%,10%	0402C
C525	2320560	Top	D	7	Chipcap 5% NPO	100p 50V normal,-5%,5%	0402C
C526	2320805	Top	C	8	CHIPCAP X5R 100N K 10V 0402	100n 10V normal,-10%,10%	0402C
C527	2320805	Top	C	8	CHIPCAP X5R 100N K 10V 0402	100n 10V normal,-10%,10%	0402C
C528	2320558	Top	F	6	Chipcap 5% NPO	82p 50V normal,-5%,5%	0402C
C529	2320552	Top	D	7	Chipcap 5% NPO	47p 50V normal,-5%,5%	0402C
C530	2320552	Top	D	7	Chipcap 5% NPO	47p 50V normal,-5%,5%	0402C

Item	Part Number	Side	X	Y	Description and value	Type
C531	2320604	Top	F	6	Chipcap 5% NPO	18p 50V normal,-5%,5%
C532	2320546	Top	F	6	Chipcap 5% NPO	27p 50V normal,-5%,5%
C600	2320481	Top	M	9	CHIPCAP X5R 1U K 6V3 0603	1u0 6.3V normal,-10%,10%
C602	2320783	Top	J	11	CHIPCAP X7R 33N K 10V 0402	33n 10V normal,-10%,10%
C603	2310793	Top	J	10	CHIPCAP X5R 2U2 K 10V 0805	2u2 10V normal,-10%,10%
C604	2320544	Top	L	8	Chipcap 5% NPO	22p 50V normal,-5%,5%
C605	2310037	Top	L	9	CHIPCAP X5R 10U M 6V3 0805	10U 6V3 normal,-20%,20%
C606	2320783	Top	L	9	CHIPCAP X7R 33N K 10V 0402	33n 10V normal,-10%,10%
C607	2320783	Top	L	9	CHIPCAP X7R 33N K 10V 0402	33n 10V normal,-10%,10%
C608	2320744	Top	L	9	Chipcap X7R 10% 50V 0402	1n0 50V normal,-10%,10%
C609	2320744	Top	L	9	Chipcap X7R 10% 50V 0402	1n0 50V normal,-10%,10%
C611	2320783	Top	L	4	CHIPCAP X7R 33N K 10V 0402	33n 10V normal,-10%,10%
C612	2320783	Top	L	3	CHIPCAP X7R 33N K 10V 0402	33n 10V normal,-10%,10%
C614	2320481	Top	L	3	CHIPCAP X5R 1U K 6V3 0603	1u0 6.3V normal,-10%,10%
C615	2320578	Top	L	4	Chipcap 5% X7R	560p 50V normal,-5%,5%
C616	2320805	Top	K	3	CHIPCAP X5R 100N K 10V 0402	100n 10V normal,-10%,10%
C618	2320584	Top	H	6	Chipcap 5% X7R	1n0 50V normal,-5%,5%
C620	2320584	Top	H	6	Chipcap 5% X7R	1n0 50V normal,-5%,5%
C623	2320544	Top	D	9	Chipcap 5% NPO	22p 50V normal,-5%,5%
C625	2320544	Top	D	9	Chipcap 5% NPO	22p 50V normal,-5%,5%
C626	2320544	Top	D	9	Chipcap 5% NPO	22p 50V normal,-5%,5%

Item	Part Number	Side	X	Y	Description and value				Type
C627	2320805	Top	J	9	CHIPCAP X5R 100N K 10V 0402	100n	10V	normal,- 10%,10%	0402C
C629	2320596	Top	T	5	Chipcap 5% X7R	3n3	50V	normal,- 5%,5%	0402C
C630	2320596	Top	T	5	Chipcap 5% X7R	3n3	50V	normal,- 5%,5%	0402C
C632	2310037	Top	K	9	CHIPCAP X5R 10U M 6V3 0805	10U	6V3	normal,- 20%,20%	0805C
C633	2320783	Top	K	9	CHIPCAP X7R 33N K 10V 0402	33n	10V	normal,- 10%,10%	0402C
C634	2320783	Top	K	9	CHIPCAP X7R 33N K 10V 0402	33n	10V	normal,- 10%,10%	0402C
C635	2320544	Top	K	8	Chipcap 5% NP0	22p	50V	normal,- 5%,5%	0402C
C636	2320544	Top	U	4	Chipcap 5% NP0	22p	50V	normal,- 5%,5%	0402C
C637	2320544	Top	U	4	Chipcap 5% NP0	22p	50V	normal,- 5%,5%	0402C
C638	2320596	Top	U	4	Chipcap 5% X7R	3n3	50V	normal,- 5%,5%	0402C
C639	2320596	Top	U	4	Chipcap 5% X7R	3n3	50V	normal,- 5%,5%	0402C
C640	2320629	Top	H	5	CHIPCAP NP0 1P0 B 50V 0402	1p0	50V	normal,- 0.1p,0.1p	0402C
C641	2320629	Top	G	6	CHIPCAP NP0 1P0 B 50V 0402	1p0	50V	normal,- 0.1p,0.1p	0402C
C702	2320584	Top	F	2	Chipcap 5% X7R	1n0	50V	normal,- 5%,5%	0402C
C703	2320778	Top	F	3	Chipcap X7R 10% 16V 0402	10n	16V	normal,- 10%,10%	0402C
C704	2320778	Top	F	3	Chipcap X7R 10% 16V 0402	10n	16V	normal,- 10%,10%	0402C
C705	2312243	Top	H	3	CHIPCAP X5R 4U7 K 6V3 0805	4u7	6V3	normal,- 10%,10%	0805C
C706	2320546	Top	H	4	Chipcap 5% NP0	27p	50V	normal,- 5%,5%	0402C
C707	2320514	Top	G	2	Chipcap +-0.25pF NP0	1p2	50V	normal,- 0.25pF,0.25pF	0402C
C710	2320584	Top	F	4	Chipcap 5% X7R	1n0	50V	normal,- 5%,5%	0402C
C711	2320778	Top	G	3	Chipcap X7R 10% 16V 0402	10n	16V	normal,- 10%,10%	0402C

Item	Part Number	Side	X	Y	Description and value				Type
C712	2320778	Top	G	3	Chipcap X7R 10% 16V 0402	10n	16V	normal,-10%,10%	0402C
C713	2320540	Top	F	7	Chipcap 5% NPO	15p	50V	normal,-5%,5%	0402C
C714	2320540	Top	F	6	Chipcap 5% NPO	15p	50V	normal,-5%,5%	0402C
C716	2320778	Top	G	4	Chipcap X7R 10% 16V 0402	10n	16V	normal,-10%,10%	0402C
C800	2320560	Top	D	4	Chipcap 5% NPO	100p	50V	normal,-5%,5%	0402C
C801	2320520	Top	D	3	Chipcap +-0.25pF NPO	2p2	50V	normal,-0.25pF,0.25pF	0402C
C802	2320805	Top	D	4	CHIPCAP X5R 100N K 10V 0402	100n	10V	normal,-10%,10%	0402C
C803	2320540	Top	E	4	Chipcap 5% NPO	15p	50V	normal,-5%,5%	0402C
C804	2320514	Top	E	4	Chipcap +-0.25pF NPO	1p2	50V	normal,-0.25pF,0.25pF	0402C
C805	2320540	Top	F	6	Chipcap 5% NPO	15p	50V	normal,-5%,5%	0402C
C806	2320540	Top	E	6	Chipcap 5% NPO	15p	50V	normal,-5%,5%	0402C
D190	4376355	Bot	S	5	TJA4 BLUETOOTH DEVICE	~	~	~	TFBGA_84_6.15X6.15
D191	4341583	Bot	S	3	1XINV 1.8-5.5V 7SZ04P5X SC70-5	~	~	~	SC70_5
D250	4376347 (RH-51/52)	Top	L	7	UEME V2.0 WDENA LEADFREE TFBGA244	~	~	~	TFBGA_244
D250	4376371 (RH-67/68)	Top	L	7	UEMEK2v0 LF WDENA TFBGA244	~	~	~	TFBGA_244
D370	4377007	Bot	Q	9	UPP_WD2-V3.2E F751748B UBGA240	~	~	~	PBGA_N241
D400	4341309	Top	G	10	DC/DC CONV 350MA TK11851 SOP8	~	~	~	SOT23L_8
D440	4342163	Bot	T	6	KAEDE V1.0 ISP1182 HVQFN32	~	~	~	HVQFN32
D460	4347173	Bot	R	6	NOR 128M+128M 1.8/1.8V FBGA44 PBFREE	8Mx16	~	~	FBGA44_H1.0
D461	4347179	Bot	S	9	SDRAM 8X16 1.8V/1.8V WFBGA60	8Mx16	~	~	WBGA_60_8.1X6.6_H0.9
D462	4347113	Bot	P	6	FLASH 4MX16 1.8/1.8V FBGA44	4Mx16	~	~	PBFREEBGA40_64MB_54MHZ_MAX
D614	4342403	Top	J	9	1X1-IN AND 1.8V 74AUC1G08 SC70-5	~	~	~	PDSO_G5
F130	5119039	Bot	V	8	SM FUSE F 2.0A 32V 0603	1.5A	~	~	0603_FUSE

Item	Part Number	Side	X	Y	Description and value				Type
G250	4700141	Top	T	10	CELL CAPACITOR 0.01MAH 3V3	3V3	~	~	BATTER_RB414H
G500	4520007	Top	C	6	VCO 3296-3980MHZ 4-BAND MAT-SUSHITA	3296-3980MHz	~	~	VCO_DCS02733
G501	4510417	Top	D	8	VCTCXO 26MHZ +-1PPM	26MHz	~	~	NGK3138C
L130	3203743	Bot	U	8	FERR.BEAD 0R03 42R/100MHZ 3A 0805	42R/100MHz	~	~	0805_BLM21
L131	3203767	Top	T	7	FERR.BEAD 240R/100M 0.4A 0R3 0402	240R/100MHz	~	~	FERRITE_BK1005
L133	3203767	Top	T	7	FERR.BEAD 240R/100M 0.4A 0R3 0402	240R/100MHz	~	~	FERRITE_BK1005
L190	3646063	Bot	T	5	CHIP COIL 22N J Q28/800M 0402	22nH	~	normal,-5%,5%	0402L
L191	3646005	Bot	T	4	CHIP COIL 2N7+-0N3 Q29/800M 0402	2n7H	~	normal,-0n3,0n3	0402L
L192	3646005	Bot	T	5	CHIP COIL 2N7+-0N3 Q29/800M 0402	2n7H	~	normal,-0n3,0n3	0402L
L193	3646063	Bot	T	4	CHIP COIL 22N J Q28/800M 0402	22nH	~	normal,-5%,5%	0402L
L194	3646063	Bot	T	4	CHIP COIL 22N J Q28/800M 0402	22nH	~	normal,-5%,5%	0402L
L220	3203741	Top	J	5	FERRITE BEAD 0R5 600R/100MHZ 0603	600R/100MHz	~	~	0603_BLM
L221	3203741	Top	J	5	FERRITE BEAD 0R5 600R/100MHZ 0603	600R/100MHz	~	~	0603_BLM
L222	3203741	Top	J	5	FERRITE BEAD 0R5 600R/100MHZ 0603	600R/100MHz	~	~	0603_BLM
L230	3648905	Bot	Q	4	CHOKE 10U 0R33 0.77A 4.6X4.6X1.2	10uH	~	~	CHOKE_D412F
L400	3203741	Top	F	10	FERRITE BEAD 0R5 600R/100MHZ 0603	600R/100MHz	~	~	0603_BLM
L401	3640119	Top	F	10	CHOKE 22U M 1R4 0.33A 3.3X3.3X1.5	22uH	~	normal,-20%,20%	CHOKE_984FB
L440	3203767	Top	U	7	FERR.BEAD 240R/100M 0.4A 0R3 0402	240R/100MHz	~	~	FERRITE_BK1005
L441	3646075	Top	U	7	CHIP COIL 56N J Q21/800M 0402	56nH	~	normal,-5%,5%	0402L
L442	3646075	Top	U	7	CHIP COIL 56N J Q21/800M 0402	56nH	~	normal,-5%,5%	0402L
L500	3646223	Top	E	8	CHIP COIL 5N6+-0N3 Q7/100M 0402	5n6H	~	normal,-0n3,0n3	0402_ELJRF
L501	3646223	Top	E	8	CHIP COIL 5N6+-0N3 Q7/100M 0402	5n6H	~	normal,-0n3,0n3	0402_ELJRF

Item	Part Number	Side	X	Y	Description and value				Type
L502	3646111	Top	E	8	CHIP COIL 3N3 +-0N1 Q30/1GHZ 0402	3n3H	~	normal,- 0n1,+0n1	0402L_H0.45
L503	3646111	Top	E	8	CHIP COIL 3N3 +-0N1 Q30/1GHZ 0402	3n3H	~	normal,- 0n1,+0n1	0402L_H0.45
L504	3646131	Top	E	7	CHIP COIL 3N9 +-0N1 Q28/1GHZ 0402	3n9H	~	normal,- 0n1,+0n1	0402L_W065_POL
L608	3645373	Top	H	5	CHIP COIL 33N G Q40/250MHZ 0603	33nH	~	normal,- 2%,2%	COIL_0603CS
L609	3645373	Top	G	6	CHIP COIL 33N G Q40/250MHZ 0603	33nH	~	normal,- 2%,2%	COIL_0603CS
L612	3203729	Top	D	9	FERRITE BEAD 0R05 220R/100M 0805	220R/ 100Mhz	~	normal,-,-	0805_BLM21
L613	3203729	Top	D	9	FERRITE BEAD 0R05 220R/100M 0805	220R/ 100Mhz	~	normal,-,-	0805_BLM21
L616	3203811	Top	U	5	FERRITE BEAD 0R58 600R/100MHZ 0402	600R/ 100MHZ	~	~	FERRITE_BK1005
L617	3203811	Top	U	5	FERRITE BEAD 0R58 600R/100MHZ 0402	600R/ 100MHZ	~	~	FERRITE_BK1005
L618	3203767	Top	U	4	FERR.BEAD 240R/100M 0.4A 0R3 0402	240R/ 100MHZ	~	~	FERRITE_BK1005
L619	3203767	Top	U	4	FERR.BEAD 240R/100M 0.4A 0R3 0402	240R/ 100MHZ	~	~	FERRITE_BK1005
L700	3203743	Top	H	4	FERR.BEAD 0R03 42R/100MHZ 3A 0805	42R/ 100MHZ	~	~	0805_BLM21
L702	3646069	Top	F	7	CHIP COIL 33N J Q23/800M 0402	33nH	~	normal,- 5%,5%	0402L
L800	3646047	Top	D	3	CHIP COIL 3N3 +-0N3 Q28/800M 0402	3n3H	~	normal,- 0n3,+0n3%	0402L
L801	3646047	Top	E	4	CHIP COIL 3N3 +-0N3 Q28/800M 0402	3n3H	~	normal,- 0n3,+0n3%	0402L
L802	3646115	Top	E	6	CHIP COIL 4N7 +-0N1 Q29/1GHZ 0402	4n7H	~	normal,- 0n1,+0n1	0402L_H0.45
L803	3646115	Top	E	6	CHIP COIL 4N7 +-0N1 Q29/1GHZ 0402	4n7H	~	normal,- 0n1,+0n1	0402L_H0.45
L804	3646067	Top	E	6	CHIP COIL 18N J Q29/800M 0402	18nH	~	normal,- 5%,5%	0402L
L805	3646067	Top	E	6	CHIP COIL 18N J Q29/800M 0402	18nH	~	normal,- 5%,5%	0402L
L807	3646055	Top	E	6	CHIP COIL 8N2 J Q28/800MHZ 0402	8n2H	~	normal,- 5%,+5%	0402L
N130	4341705	Top	K	3	CURRENT SENS LM3820 USMD10 PB-FREE	~	~	~	USMD10_2.08X1.57_H0.675

Item	Part Number	Side	X	Y	Description and value				Type
N230	4341711	Bot	O	4	DC/DC 1.8V/1.5V LM2608-1.8 USMD10	~	~	~	USMD10_2.534X2.2 8X0.675
N233	4349949	Top	K	3	VREG MAS9161B3GB06 2.5V 80MA TSOT	~	2.5V	~	TSOT_5
N310	4341761	Top	R	11	VREG & LEVEL SHIFT LP3928 USMD16	~	2.8V	~	USMD16_2.03X2.03
N400	4341137	Bot	T	9	DC/DC CONV LM3353 4.1V 80MA MSOP10	~	~	~	MSOP_10
N500	4371005 (RH-51/ 52)	Top	E	7	HELGO85 PBFREE TFBGA88	~	~	~	TFBGA88
N500	4380053 (RH-67/ 68)	Top	E	7	HELGO86G Line TFD8 TFBGA88	~	~	~	TFBGA88
N607	4342429	Top	K	4	AF AMP 0.4W LM4890/NCP2890 PBFREE	~	~	~	USMD9_1.544X1.54 4_0.675
N700	4355641	Top	F	3	PW AMP RF9250E4.1 MICRO GSM/ EDGE	~	~	~	RF_PA_PF79001B_6. 2X5.2
R106	1430690	Top	M	3	Chipres 0W06 jumper 0402	0R	~	normal,-,-	0402R
R110	1430786	Bot	Q	10	Resistor 5% 63mW	18k	~	normal,- 5%,5%	0402R
R111	1430786	Bot	Q	10	Resistor 5% 63mW	18k	~	normal,- 5%,5%	0402R
R112	1430786	Bot	Q	10	Resistor 5% 63mW	18k	~	normal,- 5%,5%	0402R
R113	1430786	Bot	Q	10	Resistor 5% 63mW	18k	~	normal,- 5%,5%	0402R
R114	1430786	Bot	Q	10	Resistor 5% 63mW	18k	~	normal,- 5%,5%	0402R
R115	1430786	Bot	P	10	Resistor 5% 63mW	18k	~	normal,- 5%,5%	0402R
R130	1430762	Top	J	4	Resistor 5% 63mW	2k2	~	normal,- 5%,5%	0402R
R131	1430762	Top	J	3	Resistor 5% 63mW	2k2	~	normal,- 5%,5%	0402R
R133	1820039	Top	M	6	NTC RES 47K J B=4050+-3% 0402	47k	~	normal,- 5%,5%	0402_NTH5
R134	1430804	Top	J	7	Resistor 5% 63mW	100k	~	normal,- 5%,5%	0402R
R135	4129011	Top	H	5	ASIP ESDA14V2-4BF2 **PB-FREE**	~	~	~	uBGA5
R136	1825233	Top	U	3	CHIP VARISTOR VWM15V VC50V 0402	15V/50V	~	-	0402_VAR
R137	1825233	Top	U	4	CHIP VARISTOR VWM15V VC50V 0402	15V/50V	~	-	0402_VAR

Item	Part Number	Side	X	Y	Description and value				Type
R191	1430830	Bot	S	3	Resistor 5% 63mW	1M0	~	normal,-5%,5%	0402R
R192	1430832	Bot	S	4	Resistor 5% 63mW	2k7	~	normal,-5%,5%	0402R
R193	1430778	Bot	S	4	Resistor 5% 63mW	10k	~	normal,-5%,5%	0402R
R194	1430691	Bot	S	4	CHIPRES 0W06 2R2 J 0402	2R2	~	normal,-5%,5%	0402R
R195	1430778	Bot	R	5	Resistor 5% 63mW	10k	~	normal,-5%,5%	0402R
R252	1430804	Top	M	8	Resistor 5% 63mW	100k	~	normal,-5%,5%	0402R
R253	1430145	Top	M	8	Chipres 0W06 100k F 200ppm 0402	100k	~	normal,-1%,1%	0402R
R254	1430804	Top	J	9	Resistor 5% 63mW	100k	~	normal,-5%,5%	0402R
R255	1820039	Top	H	9	NTC RES 47K J B=4050+-3% 0402	47k	~	normal,-5%,5%	0402_NTH5
R256	1825233	Top	P	11	CHIP VARISTOR VWM15V VC50V 0402	15V/50V	~	-	0402_VAR
R257	1825233	Top	P	11	CHIP VARISTOR VWM15V VC50V 0402	15V/50V	~	-	0402_VAR
R258	1825233	Top	P	11	CHIP VARISTOR VWM15V VC50V 0402	15V/50V	~	-	0402_VAR
R259	1414605	Top	J	6	CHIPRES 0W25 0R22 J 0805	0R22	~	normal,-5%,5%	0805R
R260	1430873	Top	L	6	CHIPRES 0W06 27K F 0402	27k	~	normal,-1%,1%	0402R
R261	4129011	Top	J	8	ASIP ESDA14V2-4BF2 **PB-FREE**	~	~	~	uBGA5
R270	1430770	Top	J	8	Resistor 5% 63mW	4k7	~	normal,-5%,5%	0402R
R310	4129071	Top	M	3	ASIP EMIF03-SIM01F2 **PB-FREE**	~	~	~	uBGA8
R311	1430690	Top	M	3	Chipres 0W06 jumper 0402	0R	~	normal,-,-	0402R
R312	1430690	Top	M	3	Chipres 0W06 jumper 0402	0R	~	normal,-,-	0402R
R315	4129101	Top	S	11	ASIP EMIF04-MMC02F2**PB-FREE**	~	~	~	uBGA11_1.62X2.12
R371	1430786	Bot	O	8	Resistor 5% 63mW	18k	~	normal,-5%,5%	0402R
R400	1430778	Top	E	10	Resistor 5% 63mW	10k	~	normal,-5%,5%	0402R
R403	1825233	Top	D	10	CHIP VARISTOR VWM15V VC50V 0402	15V/50V	~	-	0402_VAR
R405	1430804	Bot	T	8	Resistor 5% 63mW	100k	~	normal,-5%,5%	0402R

Item	Part Number	Side	X	Y	Description and value				Type
R406	1430754	Bot	T	7	Resistor 5% 63mW	1k0	~	normal,- 5%,5%	0402R
R407	1430722	Bot	T	8	Resistor 5% 63mW	68R	~	normal,- 5%,5%	0402R
R409	1430714	Top	G	10	Resistor 5% 63mW	33R	~	normal,- 5%,5%	0402R
R422	1430117	Bot	P	7	Chipres 0W06 100R F 200ppm 0402	100R	~	normal,- 1%,1%	0402R
R423	1430117	Bot	P	7	Chipres 0W06 100R F 200ppm 0402	100R	~	normal,- 1%,1%	0402R
R424	1430718	Bot	P	10	Resistor 5% 63mW	47R	~	normal,- 5%,5%	0402R
R425	1430718	Bot	P	10	Resistor 5% 63mW	47R	~	normal,- 5%,5%	0402R
R426	1430718	Bot	O	8	Resistor 5% 63mW	47R	~	normal,- 5%,5%	0402R
R428	1430754	Top	C	10	Resistor 5% 63mW	1k0	~	normal,- 5%,5%	0402R
R430	1825233	Top	C	10	CHIP VARISTOR VWM15V VC50V 0402	15V/50V	~	-	0402_VAR
R437	1430766	Bot	P	10	Resistor 5% 63mW	3k9	~	normal,- 5%,5%	0402R
R438	1430766	Bot	P	10	Resistor 5% 63mW	3k9	~	normal,- 5%,5%	0402R
R446	1430714	Top	T	7	Resistor 5% 63mW	33R	~	normal,- 5%,5%	0402R
R447	1430722	Bot	T	6	Resistor 5% 63mW	68R	~	normal,- 5%,5%	0402R
R448	1430722	Bot	T	7	Resistor 5% 63mW	68R	~	normal,- 5%,5%	0402R
R450	1825233	Top	T	8	CHIP VARISTOR VWM15V VC50V 0402	15V/50V	~	-	0402_VAR
R451	4129265	Top	T	7	ASIP EMIF02-USB02F2 **PBFREE**	~	~	~	uBGA_10_1.7X2.05
R452	1430812	Bot	T	7	Resistor 5% 63mW	220k	~	normal,- 5%,5%	0402R
R465	1430770	Bot	P	10	Resistor 5% 63mW	4k7	~	normal,- 5%,5%	0402R
R490	1430778	Top	M	6	Resistor 5% 63mW	10k	~	normal,- 5%,5%	0402R
R491	1430748	Bot	R	10	Resistor 5% 63mW	680R	~	normal,- 5%,5%	0402R
R492	1430726	Bot	R	10	Resistor 5% 63mW	100R	~	normal,- 5%,5%	0402R

Item	Part Number	Side	X	Y	Description and value	Type
R500	1430693	Top	C	5	Chipres 0W06 5R6 J 0402	5R6 ~ normal,-5%,5%
R501	1430772	Top	C	7	Resistor 5% 63mW	5k6 ~ normal,-5%,5%
R502	1430841	Top	B	7	Chipres 0W06 6k8 F 0402	6k8 ~ normal,-1%,1%
R503	1620505	Top	C	7	RES NETWORK 0W04 2DB ATT 0404	436R/11R6/436R ~ ~
R504	1430770	Top	E	8	Resistor 5% 63mW	4k7 ~ normal,-5%,5%
R505	1430770	Top	F	8	Resistor 5% 63mW	4k7 ~ normal,-5%,5%
R506	1430788	Top	F	8	Resistor 5% 63mW	22k ~ normal,-5%,5%
R511	1430770	Top	D	5	Resistor 5% 63mW	4k7 ~ normal,-5%,5%
R512	1430865	Top	D	6	CHIPRES 0W06 5K6 F 0402	5k6 ~ normal,-1%,1%
R513	1430784	Top	C	8	Resistor 5% 63mW	15k ~ normal,-5%,5%
R514	1430784	Top	F	6	Resistor 5% 63mW	15k ~ normal,-5%,5%
R515	1620065	Top	D	7	RES NETWORK 0W06 4X5K6 J 0804	4x5.6k ~ normal,-5%,5%
R516	1430700	Top	E	8	Resistor 5% 63mW	10R ~ normal,-5%,5%
R602	1430754	Top	L	8	Resistor 5% 63mW	1k0 ~ normal,-5%,5%
R603	1430754	Top	L	8	Resistor 5% 63mW	1k0 ~ normal,-5%,5%
R604	1430744	Top	L	8	Resistor 5% 63mW	470R ~ normal,-5%,5%
R605	1430762	Top	L	9	Resistor 5% 63mW	2k2 ~ normal,-5%,5%
R606	1430762	Top	L	9	Resistor 5% 63mW	2k2 ~ normal,-5%,5%
R607	1430754	Top	L	9	Resistor 5% 63mW	1k0 ~ normal,-5%,5%
R608	1430754	Top	K	9	Resistor 5% 63mW	1k0 ~ normal,-5%,5%
R609	1825233	Top	T	7	CHIP VARISTOR VWM15V VC50V 0402	15V/50V ~ -
R610	1825233	Top	T	7	CHIP VARISTOR VWM15V VC50V 0402	15V/50V ~ -

Item	Part Number	Side	X	Y	Description and value				Type
R611	1430788	Top	L	4	Resistor 5% 63mW	22k	~	normal,- 5%,5%	0402R
R612	1430788	Top	L	3	Resistor 5% 63mW	22k	~	normal,- 5%,5%	0402R
R613	1430788	Top	L	3	Resistor 5% 63mW	22k	~	normal,- 5%,5%	0402R
R614	1430790	Top	K	4	Resistor 5% 63mW	27k	~	normal,- 5%,5%	0402R
R618	1825233	Top	C	9	CHIP VARISTOR VWM15V VC50V 0402	15V/50V	~	-	0402_VAR
R619	1825233	Top	C	9	CHIP VARISTOR VWM15V VC50V 0402	15V/50V	~	-	0402_VAR
R620	1430883	Top	J	9	CHIPRES 0W06 1K5 F 100PPM 0402	1k5	~	normal,- 1%,1%	0402R
R621	1430844	Top	J	9	Resistor 1% 63mW	3k9	~	normal,- 1%,1%	0402R
R622	1430740	Top	U	4	Resistor 5% 63mW	330R	~	normal,- 5%,5%	0402R
R627	1430744	Top	T	4	Resistor 5% 63mW	470R	~	normal,- 5%,5%	0402R
R628	1430744	Top	K	8	Resistor 5% 63mW	470R	~	normal,- 5%,5%	0402R
R629	1430754	Top	K	8	Resistor 5% 63mW	1k0	~	normal,- 5%,5%	0402R
R630	1430754	Top	K	8	Resistor 5% 63mW	1k0	~	normal,- 5%,5%	0402R
R631	1430804	Top	T	3	Resistor 5% 63mW	100k	~	normal,- 5%,5%	0402R
R632	1825233	Top	U	4	CHIP VARISTOR VWM15V VC50V 0402	15V/50V	~	-	0402_VAR
R633	1825233	Top	U	4	CHIP VARISTOR VWM15V VC50V 0402	15V/50V	~	-	0402_VAR
R634	1430151	Top	U	4	Resistor 5% 100mW	10R	~	normal,- 5%,+5%	0603R
R635	4129253	Top	T	4	ASIP MIC W/ESD RES+CAP+ZDI BGA11	~	~	~	uBGA11_2.15X1.65
R701	1430754	Top	G	2	Resistor 5% 63mW	1k0	~	normal,- 5%,5%	0402R
R702	1430770	Top	F	4	Resistor 5% 63mW	4k7	~	normal,- 5%,5%	0402R
R711	1430690	Top	E	7	Chipres 0W06 jumper 0402	0R	~	normal,-,-	0402R
R712	1430690	Top	E	7	Chipres 0W06 jumper 0402	0R	~	normal,-,-	0402R
R713	1430714	Top	G	3	Resistor 5% 63mW	33R	~	normal,- 5%,5%	0402R

Item	Part Number	Side	X	Y	Description and value				Type
R715	1430714	Top	G	3	Resistor 5% 63mW	33R	~	normal,-5%,5%	0402R
R717	1620515	Top	G	2	RES NETWORK 0W04 1DB ATT 0404	870R/ 5R77/870R	~	~	0404_RAC10
R718	1620515	Top	G	4	RES NETWORK 0W04 1DB ATT 0404	870R/ 5R77/870R	~	~	0404_RAC10
R800	1430764	Top	D	4	Resistor 5% 63mW	3k3	~	normal,-5%,5%	0402R
R801	1430700	Top	E	4	Resistor 5% 63mW	10R	~	normal,-5%,5%	0402R
R802	1430746	Top	E	4	Resistor 5% 63mW	560R	~	normal,-5%,5%	0402R
S420	5209001	Top	B	9	SM SW TACT SPST 12V 50MA SIDE KEY	~	~	~	BUTTON_EVQPUA02
T500	4550187	Top	C	7	TRANSF BALUN 3600MHZ+-400MHZ	~	~	~	TRANS_LDB213
T700	4550223	Top	F	6	TRANSF BALUN 1800+-100mhz 2x1.25	~	~	~	TRANS_LDB15
T800	4550165	Top	F	5	TRANSF BALUN 1.9GHZ+-100MHZ 2X1.25	~	~	~	TRANS_LDB15
V130	4113721	Top	T	8	TVS DI 1PMT16AT3 16V 175W PWRMITE	~	~	~	CASE_457
V400	4129061	Top	E	10	ASIP 2-CH MIC EMI/ESD **PB-FREE**	~	~	~	FC6_1.65X1.15
V401	4219919	Top	G	10	TR PDTA114EE RB=RBE=10K 50V SC75	~	~	~	EM3
V402	4110473	Top	F	10	SCH DIODE 30V 200MA VF 0V5 SOD523	~	~	~	EMD2
V600	4110089	Top	I	11	DIX2 BAV70W CC 70V .5A 4NS SOT323	~	~	~	SOT323
V601	4110089	Top	I	10	DIX2 BAV70W CC 70V .5A 4NS SOT323	~	~	~	SOT323
V615	4211631	Top	U	3	MFETX2 UM6K1N N 30V 0.1A 7R SC-88	~	~	~	UMT6
V800	4210261	Top	D	4	TR BGA428 LNA1.8GHZ 19.5DB SOT363	~	~	~	SOT_363
X131	5409255	Top	I	4	SM LYNX BATT.CONN 3POL 12V 2A H7	~	~	~	LYNX_BATT_CONN
X132	5460061	Top	V	5	SM SYSTEM CONNECTOR 14POL	~	~	~	SYSCON_MQ202_N K_14R3
X310	5469283	Top	Q	5	CONN SIM 2X3POL P2.54 15V 0.5A	~	~	~	SIM_READER
X311	5409295	Top	Q	9	MMC-CONNECTOR	~	~	~	CONN_CT4_00373_210
X400	5469217	Bot	U	6	SM CONN 2X11 SPR 50V 0.5A PCB/PCB	~	~	~	CONN_R0923_22

Item	Part Number	Side	X	Y	Description and value				Type
X401	5469219	Bot	C	4	SM CONN 2X12F P0.4 30V 0.3A PCB/ PCB	~	~	~	JST_R_JAVK_G_1_R 3
X420	5409297	Top	H	8	CAMERA MOD.SOCKET 2X7POL SPR P1.4	~	~	~	SOCKET_DMD10413
X602	5400247	Top	K	11	SM CONN VIBRA SPACER PAD 2.8X1.8	~	~	~	CONTACT_PAD_2.95 X1.95
X603	5400247	Top	K	10	SM CONN VIBRA SPACER PAD 2.8X1.8	~	~	~	CONTACT_PAD_2.95 X1.95
X604	5400247	Top	L	11	SM CONN VIBRA SPACER PAD 2.8X1.8	~	~	~	CONTACT_PAD_2.95 X1.95
X605	5400247	Top	L	10	SM CONN VIBRA SPACER PAD 2.8X1.8	~	~	~	CONTACT_PAD_2.95 X1.95
X607	5400247	Top	L	11	SM CONN VIBRA SPACER PAD 2.8X1.8	~	~	~	CONTACT_PAD_2.95 X1.95
X812	5406941	Top	C	4	CON PPP ANTENNA R1024 DMD11562	~	~	~	CONN_ANT_DMD11 562
X813	5406941	Top	C	5	CON PPP ANTENNA R1024 DMD11562	~	~	~	CONN_ANT_DMD11 562
Z191	4550265	Bot	T	4	CER FILT 2441+-41.75MHZ 2.5X2.0	2441MHz	~	~	FILTER_BLUEBIRD_1 _3
Z192	4550267	Bot	T	5	TRANSF BALUN 2400+-100MHZ	~	~	~	TRANS_LDB213
Z400	4129031	Bot	U	8	ASIP EMIF10-1K010F2 **PB-FREE**	~	~	~	uBGA24_2.62X2.62
Z401	4129031	Bot	U	4	ASIP EMIF10-1K010F2 **PB-FREE**	~	~	~	uBGA24_2.62X2.62
Z402	4129035	Top	D	10	ASIP 10-CH ESD EMI FILTER BGA25	~	~	~	uBGA25_2.69X2.69
Z700	4511443 (RH-51, RH-67)	Top	F	7	SAW FILT 897.5+-17.5MHZ 2.0X1.6	897.5MHz	~	~	FILTER_T2B_H0.78
Z700	4511445 (RH-52, RH-68)	Top	F	7	SAW FILT 836.5+-12.5MHZ 2.0X1.6	836.5MHz	~	~	FILTER_T2B_H0.78
Z800	4550305	Top	E	3	DIPL+3SW 824-960/1710-1990MHZ 5.4X4	824-960/ 1710- 1990MHz	~	~	ANT_SW_5.6X4.2
Z801	4511459	Top	D	3	SAW FILT 1960+-30MHZ 2.0X1.6	1960MHz	~	~	FILTER_T2UB_H0.78
Z802	4511457	Top	E	5	SAW 1842.5+-37.5MHZ 2.0X1.6	1842.5MHz	~	~	FILTER_T2B_H0.78
Z803	4511455 (RH-51, RH-67)	Top	E	5	SAW 942.5+-17.5MHZ 2.0X1.6	942.5MHz	~	~	FILTER_T2B_H0.78
Z803	4511449 (RH-52, RH-68)	Top	E	5	SAW 881.5+-12.5MHZ 2.0X1.6	881.5MHz	~	~	FILTER_T2B_H0.78

Component layout diagram bottom

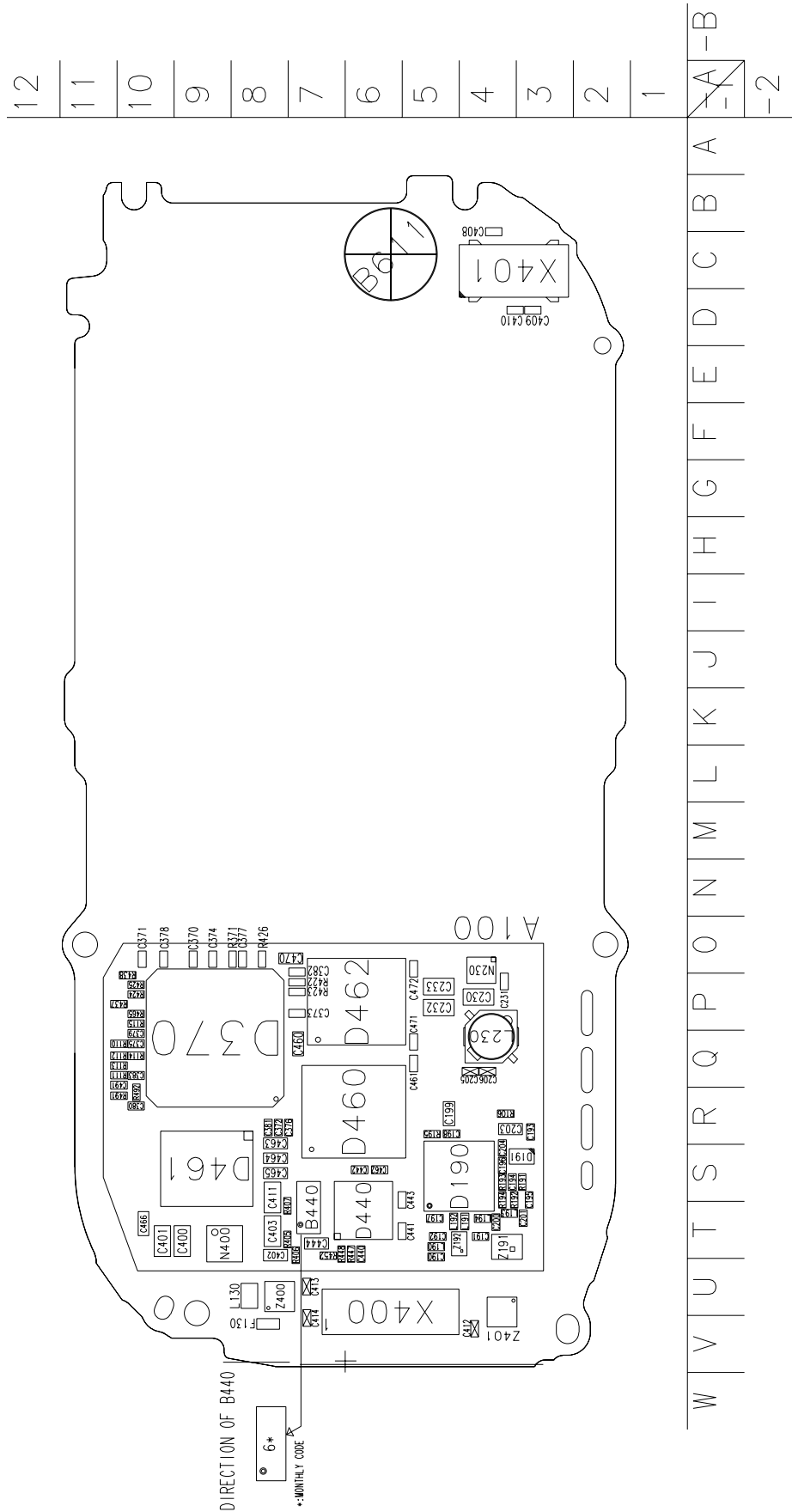

Component layout diagram top

